

**MODEL
GGSWC193**

V 1.0 | 0821



ESSENTIALS FOR LIFE

User Manual

193 Bottle Dual Zone Wine Cabinet

SÔLT

Purchase Details



For future reference, please record the following information which can be found on the rating plate and the date of purchase which can be found on your sales invoice.

STORE DETAILS

STORE NAME | _____

ADDRESS | _____

TELEPHONE | _____ PURCHASE DATE | _____

PRODUCT DETAILS

MODEL NO. | _____

SERIAL NO.* | _____

Contents	2	Purchase Details
	5	Welcome
	6	General Safety Instructions
	10	Your Wine Cabinet
	11	Getting Started
	12	Installation
	18	Operating Instructions
	20	Bottle Arrangement
	21	Tips for Wine Storage
	22	Cleaning & Maintenance
	23	FAQ's & Troubleshooting
	24	Technical Specifications
	25	Attach Your Receipt
	26	Warranty Information

Customer Care

Sôlt recommends the use of original spare parts. When contacting our customer service team, please ensure that you have the following information at hand (which can be found on your appliances' rating plate).

- Model Number
- Serial Number

**This page
is intentionally
left blank**

Welcome

Congratulations on purchasing your new Wine Cabinet! The Sôlt brand is proudly distributed within Australia by Residentia Group Pty Ltd.

Residentia Group

—
Head Office.
165 Barkly Ave
Burnley
Victoria 3121
Australia

—
ACN.
600 546 656

—
Online.
residentia.group

Sôlt

—
Online.
www.solt.house

—
Instagram.
[/solt.house](https://www.instagram.com/solt.house)

—
Facebook.
[/solt.appliances](https://www.facebook.com/solt.appliances)

Please refer to the warranty card at the rear of this manual for information regarding your product's parts and labour warranty, or visit us online at www.residentia.group

At Residentia Group, we are customer obsessed and our Support Team are there to ensure you get the most out of your appliance. Should you want to learn more about your appliance features, and importantly taking care of your appliance when cleaning, our Support Team are here to help.

You can use our online Support Centre at anytime by visiting <http://support.residentiagroup.com.au>, or you can contact us via calling us on 1300 11 HELP (4357).

It is important that you read through the following use and care manual thoroughly to familiarise yourself with the installation and operation requirements of your appliance to ensure optimum performance.

Again, thank you for choosing an Sôlt appliance and we look forward to being of service to you.

Kind Regards,
The Residentia Team

General Safety Instructions

IMPORTANT INFORMATION THAT MAY IMPACT YOUR MANUFACTURER'S WARRANTY

Adherence to the directions for use and installation guidelines within this manual is extremely important for both your health and safety. Failure to strictly adhere to the requirements within this manual may result in personal injury, property damage and affect your ability to make a claim under the Solt manufacturer's warranty provided with your product. Products must be used, installed and operated in accordance with this manual. You may not be able to claim on the Solt manufacturer's warranty in the event that your product fault is due to failure to adhere to this manual.

IMPORTANT SAFETY INSTRUCTIONS READ CAREFULLY AND KEEP FOR FUTURE REFERENCE

Read this manual thoroughly before first use, even if you are familiar with this type of product. The safety precautions enclosed herein reduce the risk of fire, electric shock and injury when correctly adhered to. Make sure you understand all instructions and warnings.

Keep the manual in a safe place for future reference, along with the completed warranty card and purchase receipt. If you sell or transfer ownership of this product, pass on these instructions to the new owner.

Always follow basic safety precautions and accident prevention measures when using an electrical appliance, including the following:

IMPORTANT: Pay particular attention to messages that contain the words **DANGER**, **WARNING** or **CAUTION**. These words are used to alert you to a potential hazard that can seriously injure you and others. The instructions will tell you how to reduce the chance of injury and let you know what can happen if the instructions are not followed.



This symbol alerts you to take care as this appliance contains a flammable refrigerant (isobutane) and insulation blowing gas (cyclopentane). Do not expose it to high heat, sparks and open flames.

The refrigerant isobutane (R600) is contained within the refrigerant circuit of the appliance, a gas with a high level of environmental compatibility, which is nevertheless flammable. During transportation and installation of the appliance, ensure that none of the components of the refrigerant circuit become damaged.

WARNING: Do not damage the refrigerant circuit! Never use an appliance with a damaged refrigerant circuit! If the refrigerant circuit becomes damaged, avoid proximity to open fires and all types of heat and ignition sources. Thoroughly ventilate the room in which the appliance is located.

DANGER: It is hazardous for anyone other than an authorised service person to service this appliance.

In Queensland, the authorised service person MUST hold a Gas Work Authorisation for hydrocarbon refrigerants to carry out servicing or repairs which involve the removal of covers.

The room for installing the appliance must be at least 1m. per 8g of refrigerant. The amount and type of refrigerant in the appliance can be found in the Technical Specifications section of this user manual and on the rating plate, found on the rear of the appliance.

The information in this user manual is subject to modification without any prior notice. Updated manuals will be made available online via the Solt website.

Solt offers no guarantee for our Wine Cabinet if it is being used for any purpose other than that for which it was specifically designed.

Solt cannot be held responsible for any error in this manual.

USAGE CONDITIONS AND RESTRICTIONS

- Domestic use only: This appliance is intended for indoor household use only. It is not intended for commercial, industrial or outdoor use. It is not intended for use in a recreational vehicle.
- Purpose: Do not use this appliance for anything other than its intended purpose. Other uses are not recommended and may cause fire, electric shock or personal injury.
- Attachments: The use of attachments is not recommended by the appliance manufacturer and distributor as they may be hazardous.
- Improper use: Damage due to improper use, or repairs made by unqualified personnel will void your warranty. We assume no liability for any eventual damages caused by misuse of the product or noncompliance with these instructions.

WARNING: Do not use mechanical devices or other means to accelerate the defrosting process, other than those recommended by the manufacturer.

- Usage restriction: This appliance is not intended for use by persons (including children) with reduced physical, sensory or mental capabilities, or lack of experience and knowledge, unless they have been given supervision or instructions concerning use of the appliance by a person responsible for their safety.
- Children: Supervise young children to ensure they do not play with the appliance. Never allow children to operate, play with, climb or crawl inside the appliance.
- **WARNING:** Do not use electrical appliances inside the appliance, unless they are of the type recommended by the manufacturer.
- Explosive or flammable substances: Do not store explosive substances such as aerosol cans with a flammable propellant in this appliance. Do not store or use petrol or any other flammable vapours and liquids in the vicinity of this or any other appliance. Do not use such substances for cleaning the appliance. The fumes can create a fire hazard or an explosion.
- Damage: Do not use the appliance if the power cord, plug or the appliance itself is damaged. If the cord is damaged, contact the after sales support line and have the cord replaced by qualified personnel in order to avoid a hazard.
- **WARNING:** Do not damage the refrigerant circuit.
- Do not modify: Do not attempt to alter or modify this appliance in any way.
- Repair: Do not attempt to repair or replace any part of this appliance unless it is specifically recommended in this manual. All other servicing should be referred to a qualified technician. Contact our Customer Care team for advice.
- **WARNING:** Do not locate power-boards or portable power supplies at the rear of the appliance.
- Usage: The gaps between cooler door and cooler body are small- be careful to avoid jamming your fingers in these areas. Please be gentle when closing or opening the Wine Cabinet door.
- Care: Never stand on the base of the Wine Cooler or any of the shelving.

ELECTRICAL SAFETY

- Voltage: Before connecting and turning on the appliance, ensure the electrical voltage and circuit frequency correspond to that indicated on the appliance rating label.

- Earthing: This appliance should be properly earthed for your safety. The power cord of this appliance is equipped with a three-prong plug for use in standard wall outlets to minimise the possibility of electrical shock. Do not modify the cord and/or plug provided with the appliance. Improper use of the earthed plug can result in the risk of electric shock.
- Connection: This appliance requires a standard 220-240 V AC 50Hz electrical outlet. Do not overload the electrical circuit.
- Power cord: Do not kink or damage the power cord; do not leave it exposed or dangling. Secure it at the back of the appliance so no one steps on or places anything on the cord or against it. Keep the cord out of reach of children. When moving the appliance, make sure not to damage the power cord. When removing the power cord, firmly grasp the plug and pull out it from the socket directly.
- Auxiliary Items: Do not use an inverter, adaptor or extension cord with this appliance. If the cord is too short, have a qualified electrician install an outlet near the appliance. Use of an extension cord and an inverter can negatively affect the performance of the unit.
- Protect from moisture: To protect against the risk of electric shock, do not immerse the unit, cord or plug in water or spray it with any other liquid. Do not connect or disconnect the electric plug when your hands are wet. Turn the power switch off before removing the plug from the socket.
- **WARNING:** Disconnect! To reduce the risk of fire, electric shock or personal injury, always unplug the appliance from the socket when not in use, when moving and before cleaning or servicing. Never unplug the unit by pulling the power cord. Always grip the plug firmly and pull straight out from the power point.
- Electrical work: Any electrical work required for the installation of this appliance should be carried out by a qualified electrician.
- Internal LED lighting: Your appliance is fitted with long life LED lighting. In the unlikely event the LED lights should fail, then the LED lights should be serviced by the manufacturer, its service agent or similarly qualified persons in order to avoid a hazard.

Never use this appliance with a damaged refrigerant circuit! If the coolant circuit becomes damaged, avoid proximity to open fires and all types of heat sources. The room in which the appliance is located should be ventilated for a few minutes.

WARNING: Leaking Gas: In the case of leaking gas, turn off the valve of the leaking gas, open the doors and windows in case of leakage of gas and other flammable gases. Do not unplug the cooler and other electrical appliances considering that spark may cause a fire.

General Safety Instructions (Cont.)

INSTALLATION

Heavy: This appliance is heavy, take care when moving it. To avoid back or other injury, consider a two person lift or mechanical aid when installing it. Failure to do so can result in a back or other injury.

Damage: When unpacking, check the appliance carefully for damage. If it is damaged, do not install the appliance. Contact our after sales support centre on 1300 11 43 57 for advice on examination or return of the damaged appliance.

Protect from moisture: Install the appliance in an indoor area protected from wind, rain, water spray or drips. **Protect from heat:** Do not install the appliance next to an oven, grill or other source of high heat, or where it will be exposed to direct sunlight.

WARNING: Ventilation: To ensure proper ventilation, keep any ventilation openings, in the appliance enclosure or in the built-in structure, clear of obstructions. Ensure adequate air circulation around the appliance to prevent overheating. This is a freestanding model which can be built-in providing the ventilation requirements are followed within this manual. **Level:** Install the appliance level in order to ensure proper operation.

Location: To ensure safety, the location of your Wine Cabinet should:

- be unencumbered and well ventilated;
- be well away from any heat source and direct sunlight;
- be well ventilated and not too damp (i.e. avoid laundries, bathrooms, etc);
- be indoors (avoid outdoor environments such as garages, even where they are roofed);
- have a flat, solid and level floor;
- have a standard and reliable electricity supply (including normal power outlet which is earthed);

Note! It's not recommended connecting your wine cabinet or beverage centre to a power-board or extension lead.

- have a surge protector fitted to the electrical outlet;
- be away from any microwave ovens. Certain microwave ovens do not have wave interference shields and when placed within 1 meter of your wine cabinet, they may affect its operation.
- be located where the ambient temperature is between 5°C and 35°C. If the ambient temperature is outside (above or below) this range, the performance of your appliance may be affected.

Children: Do not give packaging and other components to children to play with. The bending board and plastic film may lead to suffocation! Children should be supervised to ensure that they do not play with the appliance. Never allow children to enter or climb the wine cabinet in order to prevent children from being sealed inside or injured by the falling appliance.

CLEANING AND MAINTENANCE

Disconnect: Unplug the appliance before cleaning or servicing. Failure to do so can result in electric shock, injury or death. Do not connect or disconnect the plug when your hands are wet.

Flames: Do not let open flames or ignition sources enter the appliance.

Flammable/explosive substances: Never clean this appliance with flammable fluids. Do not store or use volatile, flammable or explosive propellants or liquids in or close to this or any other appliance. The fumes can create a fire hazard or explosion.

Washing: Do not spray or wash the appliance; do not put the wine cabinet in moist places that could allow the appliance to be easily splashed with water so as not to affect the electrical insulation properties of the cooler.

Solvents: Do not use solvent based cleaning agents or abrasives on the interior as these may damage or discolour the surfaces of the appliances.

WARNING! Do not use mechanical devices or other means to accelerate the defrosting process. Never use a sharp or metal instrument to remove frost or clean the appliance. Use a plastic scraper, if necessary. **Service:** Do not attempt to repair, modify or replace any part of the appliance unless specifically recommended in this manual. Refer all other servicing to a qualified technician, or contact our Customer Care team for advice on examination or repair of the appliance.

WARNINGS RELATED TO PLACING ITEMS

- **Objects:** Do not place heavy objects on the top of the Wine Cabinet considering that objects may fall when open or close the door, and accidental injuries might be caused.
- **Items in the cooler:** Do not put flammable, explosive, volatile and highly corrosive items in the cooler to prevent damages to the product or fire accidents.
- **Flammable items:** Do not place flammable items near the cooler to avoid fires.
- **Usage:** This product is household cooler and this equipment can only be used for the storage of wine. According to the standard requirements, household cooler shall not be used for other purposes, such as storage of blood, drugs or biological products.
- **Keys:** This model is fitted with a lockable door. Always ensure that the keys are kept out of the reach of children and not in the vicinity of the appliance, in order to prevent children from accessing.

ENERGY WARNINGS

- Wine Cabinet might not operate consistently when used for an extended period of time below the cold end of the range of temperatures for which the appliance is designed for.

RESPONSIBLE DISPOSAL

Note: At the end of its working life, do not throw this appliance out with your household rubbish. Electrical and electronic products contain substances that can have a detrimental effect on the environment and human health if disposed of inappropriately. Observe any local regulations regarding the disposal of electrical consumer goods and dispose of it appropriately for recycling and recovery of the refrigerant and blowing agent. Contact your local council for advice on recycling facilities in your area. When the wine cooler is scrapped, disassemble the doors, and remove gasket of door and shelves; put the doors and shelves in a proper place, so as to prevent entrapment of any children.

WARNING! This refrigeration appliance contains flammable refrigerants and insulation blowing gases, which must be removed before disposal. Contact your municipal authorities for any codes or regulations concerning the disposal of such materials.

For more detailed information about treatment, recovery and recycling of this product, please contact your local city office, your household waste disposal service or the shop where you purchased the product.

Your Wine Cabinet

PRODUCT OVERVIEW

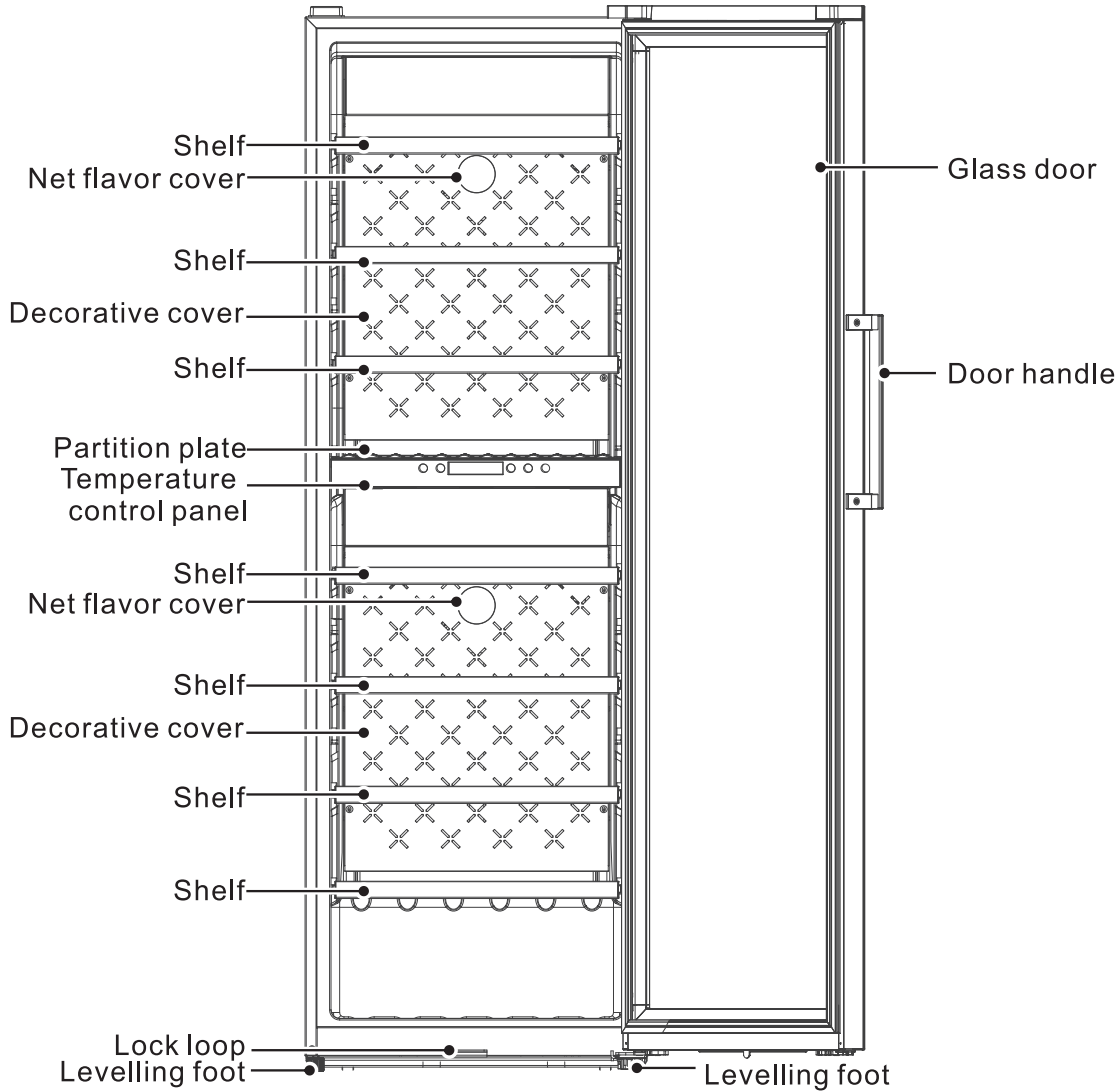

Figure 1- Diagram of your Solt wine cabinet layout.

Note: The diagram in Figure 1 above is for general reference only and your physical appliance may differ.

Tip! We recommend that the upper and lower zones of your wine cabinet are set at 12°C for improved energy efficiency. The shelves have been positioned in the most energy-efficient positions during assembly.

Note: The wine cabinet relative humidity is maintained between 50% and 80%.

Note: The wine cabinet temperature range for each zone is 5-18°C and is only intended for storing unopened bottled wine.

Important! Never place food within the wine cooler, in order to prevent bacterial contamination.

Getting Started

UNPACKING

- **Packaging materials:** This appliance has been packaged to protect it against transportation damage. Remove all packaging materials from around and inside the appliance including the bottom cushions, foam pads, tapes inside the cooler, tear off the protective film on the door and the cooler body. Keep the original packaging carton and materials in a safe place. It will help prevent any damage if the product needs to be transported in the future, and you can use it to store the appliance when it is not in use. In the event the carton is to be disposed of, please recycle all packaging materials where possible.
- **Check:** to see if all items are present.
- **Inspect:** the equipment and accessories for transport damage. In case of complaints, the supplier is to be informed immediately.
- **Suffocation:** Plastic wrapping can be a suffocation hazard for babies and young children, so ensure all packaging materials are out of their reach and disposed of safely.
- **Power cord:** Unwind the power cord to its full length and inspect it for damage. Do not use the appliance if it or its cord have been damaged or are not working properly. In case of damage, contact our after sales support line for advice on examination, repair or return of the damaged product.
- **Read the manual:** Read this manual to familiarise yourself with the appliance. Pay particular attention to the safety instructions on the previous pages.
- **Clean:** To remove any dust from transit and storage, clean the interior and exterior surfaces of the appliance with lukewarm water and a soft cloth. Dry thoroughly.
Important! Do not use harsh or abrasive detergents or powders as these will damage the finish.

FIRST USE

Before turning on your wine cabinet for the first time;

- The appliance must be rested for at least 24 hours in its location, before connecting power and switching on.
- Clean the inner chamber and leave the door open during this 24-hour resting period to allow any residual odours to clear.
- Do not connect the appliance to an electronic energy saving plug or converter that can convert DC into AC (E.g.: solar energy system, ship grid).
- Water drop or frost will be generated on back side of wine cooler when compressor is running. This is a normal function of wine cabinets, wiping out frost or water drop is not required as they will evaporate automatically. The defrosted water will be collected into drain tank and then inflow into water disposal pan above the compressor and vaporized.

Installation

Floor surface: This appliance must be properly positioned on a dry, sturdy, level surface that is strong enough to support it when it is fully loaded. Rotate left or right to adjust the levelling feet if unstable. If it is to be placed on carpet, support it with a wooden board underneath. Please use a spirit level to ensure your wine cabinet is level on both the side and front.

Clearances (Freestanding): Ensure that air can circulate freely around the back of the cabinet, which is necessary to cool the compressor and condenser. Allow at least 30mm clear space at the back and at the sides of the appliance and 30cm at the top. Failure to do so will increase compressor's power and further increase power consumption. It is also necessary to maintain distance for doors to open at least 90 degrees.

Important! Failure to allow for these clearances with the positioning of your wine cabinet will void your Manufacturer's Warranty.

In-built installation: Where installing the wine cabinet as a freestanding unit against a wall or built into a cavity or lined up with other appliances, it is important that the appliance is well ventilated and that air can circulate unhindered above, below and around it. Figure 2 below illustrates the minimum necessary air circulation for an in-built installation.

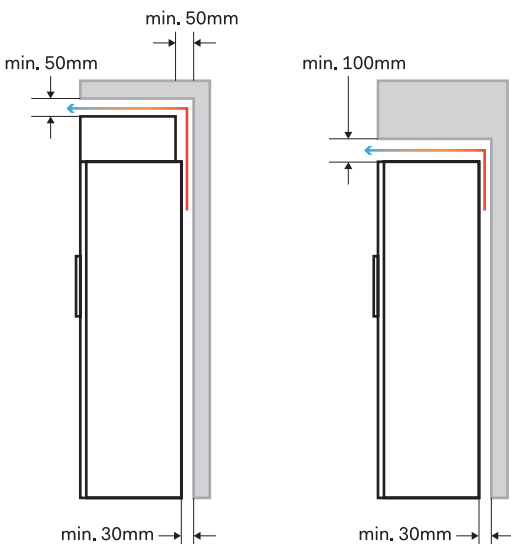

Figure 2 – Minimum ventilation requirements when building-in the appliance.

Tip! When building the appliance into a cabinet (with the required ventilation) or next to another appliance, you will need to leave a small clearance space on the side the door is hinged. This is to allow for the door to open.

DO NOT install/use the appliance in the following locations/situations:

- In moist areas or areas of high humidity (i.e. laundries, bathrooms, etc).
- In a recreational vehicle, or for use with an inverter.
- In direct sunlight, near heat sources, next to an open flame, cooking or heating appliance, or near any other source of high heat.
- Direct sunlight may affect the acrylic coating and heat sources may increase the unit's power consumption. For best energy efficiency install the appliance in the coolest area of the room.
- In an area with extreme cold ambient temperatures. Never install your wine cabinet in enclosed outdoor environments including garages.
- In an area with excessive moisture and high humidity. Make sure it is protected from elements such as wind, rain, water spray or drips.
- In an area where petrol or other explosive and/or flammable liquids or fumes are used or stored. The fumes can create a fire hazard or explosion.

ENERGY SAVING TIPS

- The appliance should be placed in the coolest area of the room, away from heat producing appliances or heating ducts. A suitable insulation board shall be applied if necessary.
- Please avoid placement in direct sunlight.
- Try to shorten opening time of cooler's door. Regular opening of your Wine Cabinet door may lead to condensation on the glass door, particularly if the external air is humid.

HANDLE INSTALLATION

- Remove the door handle accessory package from within the Wine Cabinet and remove the handle from the packaging. Hold the handle on to the glass door, aligning the holes on the handle with those pre-drilled on the door side. Use the Allen key wrench to screw the screws into place.

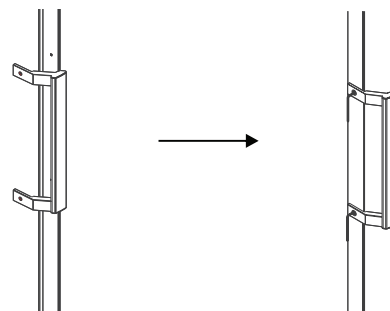

Figure 3 – Installing the handle on to the door.

REVERSING THE DOOR

If you would like to reverse the hinging of your Wine Cabinet door, please follow the steps below.

Parts to be used when reversing the door:

Description	Qty	Notes
Upper right hinge cover	1	Pre-installed on the wine cabinet, remove it when changing the door (put aside in case you wish to reverse the door back in the future)
Upper right hinge	1	Pre-installed on the wine cabinet, remove it when changing the door (put aside in case you wish to reverse the door back in the future)
Top cover	1	Pre-installed on the wine cabinet, remove it when changing the door- this will still be used
Lower right hinge	1	Pre-installed on the wine cabinet, remove it when changing the door (put aside in case you wish to reverse the door back in the future)
Upper left hinge cover	1	Part is located within the accessory package and only to be used when reversing the door
Upper left hinge	1	Part is located within the accessory package and only to be used when reversing the door
Lower left hinge	1	Part is located within the accessory package and only to be used when reversing the door
Adjustable foot	1	Pre-installed on the wine cabinet
Door right limit	1	Pre-installed on the wine cabinet, remove it when changing the door (put aside in case you wish to reverse the door back in the future)
Anti-collision block	1	Pre-installed on the wine cabinet
Door left limit	1	Part is located within the accessory package and only to be used when reversing the door
Hinge sleeve	1	Pre-installed on the wine cabinet
Temperature and humidity sensor	1	Pre-installed on the wine cabinet
Magnetic control switch	1	Pre-installed on the wine cabinet
Pin	2	Pre-installed on the wine cabinet

Table 1- Parts to be used when reversing the door.

Installation (Cont.)

Follow these steps to reverse your Wine Cabinet door hinging.

Important! The glass door is heavy and this process will require at least two able bodied people to safely undertake.

1. Unscrew the two screws (1) holding the Upper Right Hinge Cover (2) in place. Also unscrew the one screw (4) securing the Top Cover (3) in place.
2. Remove the Upper Right Hinge (5) by unscrewing the three screws (4), then remove the glass door (6) (this is heavy, please be careful!).

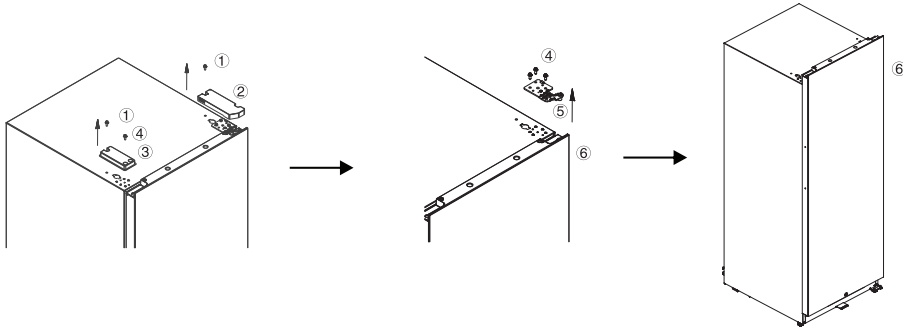

Figure 4 – Reversing the door: Steps 1 & 2.

3. Remove the ambient temperature sensor (13) and magnetic control switch (14) located in the upper right hinge cover (2) and unplug the two wire terminals (15) and (16) connected to the cabinet.

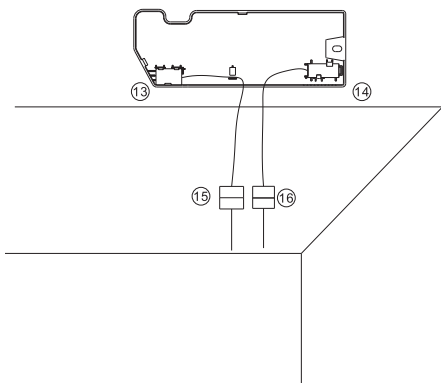

Figure 5 – Reversing the door: Step 3.

4. Remove the lower right hinge (8) by removing the 3 screws (7). Also unscrew the adjustable foot on the left (9).

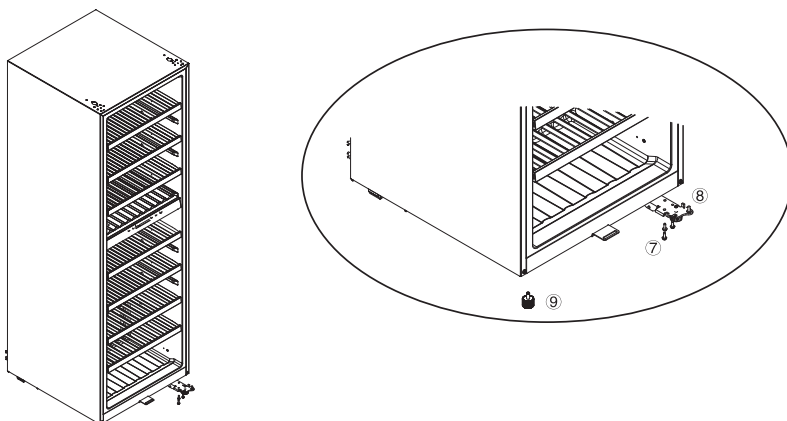

Figure 6 – Reversing the door: Step 4.

- Take the Lower Left Hinge (10) from the accessory package and fix it into place using the 3 screws removed from the right side in step 4.

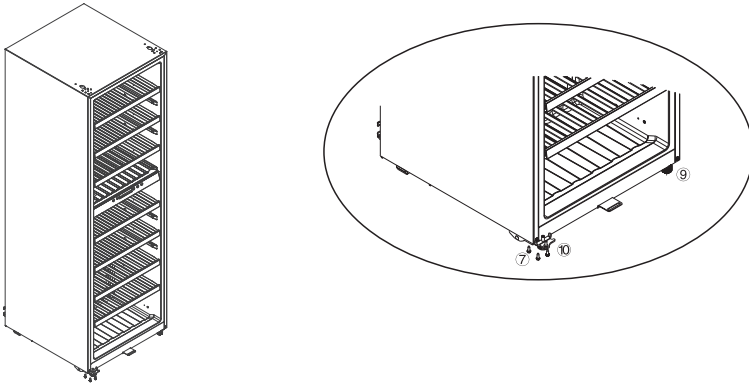

Figure 7 – Reversing the door: Step 5.

- Remove the 2 screws (1) on the lower side of the door, remove the Door right limit (18) on the right side of the door, as well as the anti-collision block (19) installed on the left side.

Take out the Door left limit from the accessory pack and install it on the left side of the door. At the same time, install the anti-collision block (19) on the right side of the door.

Take our the hinge sleeve (17) on the upper right side of the door and install it on the left side. Remove the pins (21) in the holes on the right side of the door and insert them into the holes on the left.

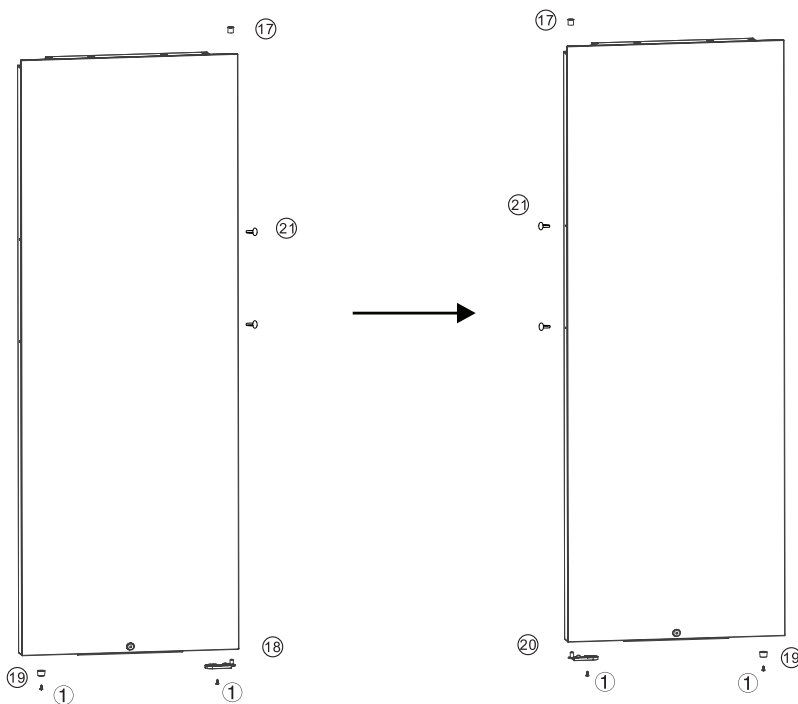

Figure 8 – Reversing the door: Step 6.

Installation (Cont.)

7. After positioning the glass door on the cabinet through the lower hinge (10), take out the upper left hinge (11) and the upper left hinge cover (12) from the accessory package and install the hinge on onto the cabinet with the 3 screws (4) removed from step 1. The ambient temperature sensor (13) and the magnetic control switch (14) remove in step 2 are installed in the hinge cover, connecting the wire terminal (15) and (16). The Left upper hinge cover (12) and the top cover (3) and respectively installed with the two screws (1) and one screw (4) on the left and right hand sides of the cabinet.

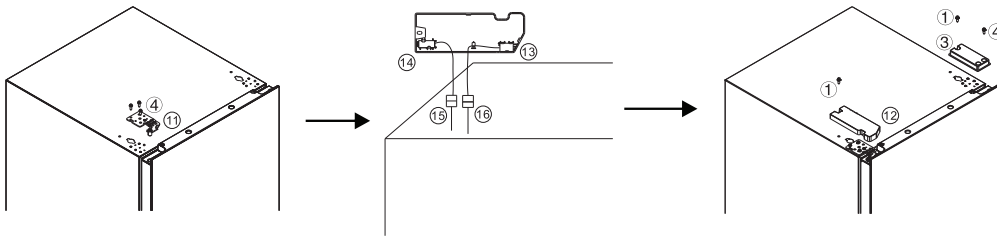

Figure 9 – Reversing the door: Step 7.

8. Lastly, install the handle on the right hand side of the door, using the pre-drilled holes.

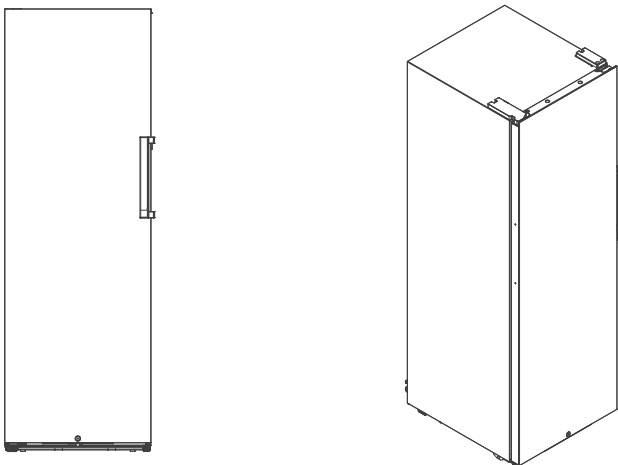

Figure 10 – Reversing the door: Step 8.

Tip! Keep the left over hinges, cover and door limit for future use in case you wish to reverse the door back to the original configuration.

REPLACE THE HUMIDIFICATION FILTER ELEMENT (OPTIONAL)

Remove the humidification filter cover installed on the zone partition board (the filter cover clicks into place) and take out the humidification filter from its housing. Replace the filter purchased from Solt or an equivalent distributor and reinstall the filter cover.

Note: You do not need to remove the zone partition board to complete this process.

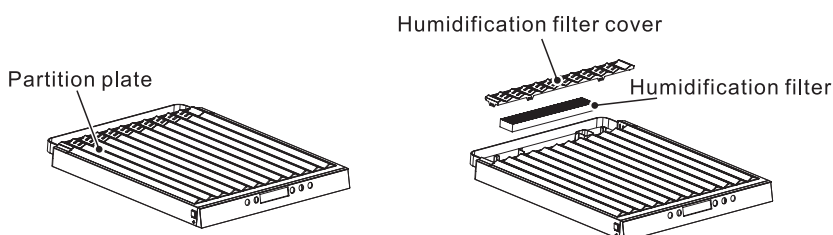

Figure 11 – Accessing the humidification filter.

**This page
is intentionally
left blank**

Operating Instructions

TEMPERATURE CONTROL

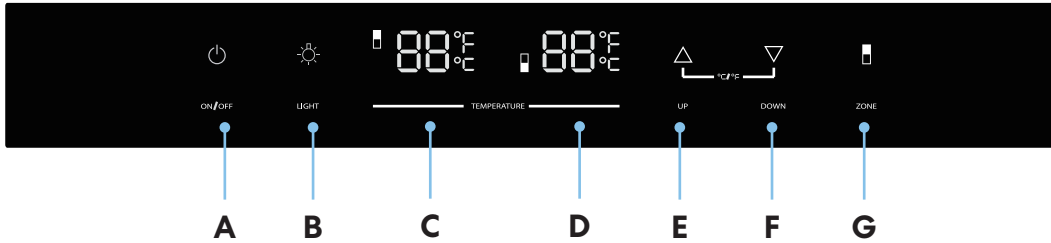

Figure 12 – Touch control panel.

Note: Figure 12 above is for general reference only and your physical appliance may differ.

- A Standby button
- B Light button
- C Temperature display for the upper zone
- D Temperature display for the lower zone
- E Increase button
- F Decrease button
- G Zone selector (Upper or Lower)

FIRST OPERATION

When your Wine Cabinet is powered on initially, the LED display will light up all elements for 3 seconds and an audible start-up tone will sound. After 3 seconds, the display will be enabled for normal operation.

Note: The LED display will be used to display any error codes in the event of an issue or component failure.

CAUTION: The wine cabinet can be controlled using the touch control panel through gently touching the buttons on the touch screen. Please keep this touch control panel away from magnetic fields and high-humid environments, as these can effect its operation.

Standby Function

Press and hold the Standby button for 5 seconds to Power On or Power Off your Wine Cabinet.

Light

Your wine cabinet features long-life LED lighting which will automatically switch on when the wine cabinet door is opened and will switch off when the door is closed. You can also turn on or off the lighting by pressing the Light button. Once the light button has been used to turn the lights on or off, the lighting will no longer be controlled through the door opening or closing (this can be reset by turning the appliance off).

Adjusting the Temperature

To adjust the temperature for your selected zone, firstly select the zone you wish to set the temperature for by pressing the Zone Selector button.

Then use the Increase button and Decrease button to adjust your temperature setting within the range of 5-18°C. The temperature will increase or decrease by 1°C with each press.

Once you have set your preferred temperature, the setting will take effect automatically after 30 seconds.

Converting between Celcius or Fahrenheit

Your wine cabinet will be set to displaying the temperature as Celcius, however you can change this to Fahrenheit if this is your preferred setting. To change your display, simply press and hold both the Increase and Decrease buttons simultaneously for 3 seconds.

Tip! When set to Fahrenheit, the temperature range for each zone changes to 41-64°F.

**This page
is intentionally
left blank**

Bottle Arrangement

BOTTLE ARRANGEMENT:

- To maintain good air circulation in the cooler, do not let any bottles touch the back wall of wine cooler.
- The bottle number here may be different from bottles in different shape and size.
- The capacity for bottle storage in the wine cabinet is based on the following marked bottle size. Oversized bottle may have impact on the number of bottle storage in the wine cabinet.

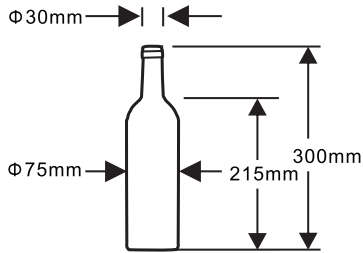

Figure 13 – Standard wine bottle measurements.

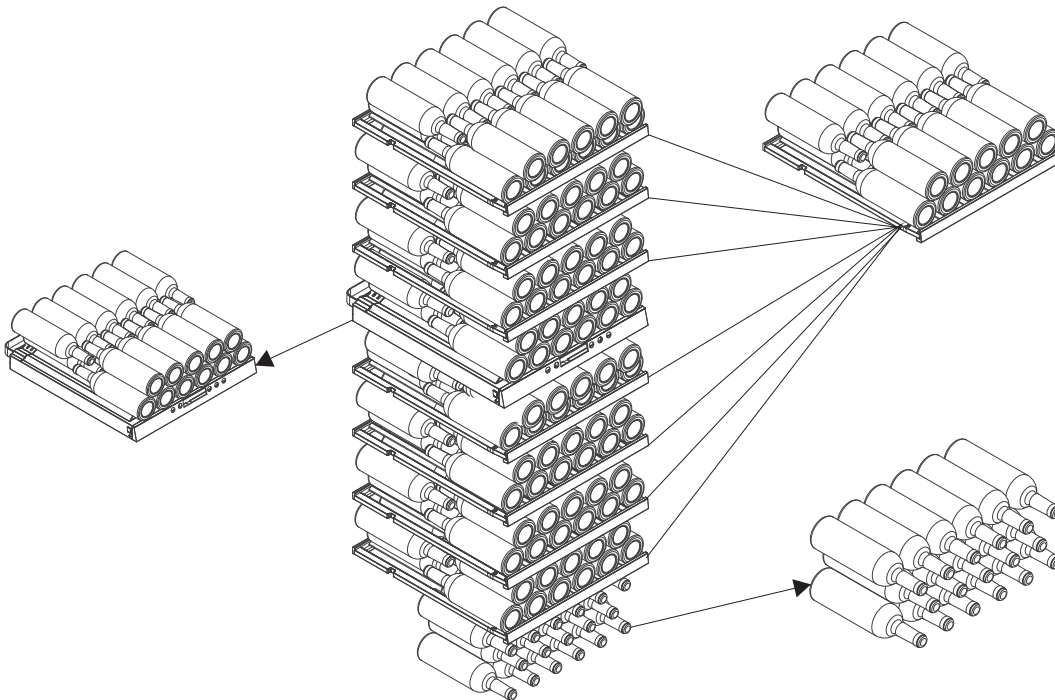

Figure 14 – Diagram showing the layout of the wine bottles to achieve maximum capacity.

Tips for Wine Storage

PRACTICAL WINE STORAGE TIPS

- Do not store bottled wine in a box or case within the wine cabinet.
- The cork of an old bottle should always be soaked in the wine when storing in a wine cabinet. Air space is not recommended between wine and cork.
- Recommendations before drinking: Placing lightly coloured red wine out on the table 2–5 hours before drinking and red wine for 4–5 hours so they can reach the suitable serving temp. Opening the bottles during this period can assist with the service of heavier red wines as well. White wine can be placed on the table right away. Champagne should always be stored in the cooler and taken out only before drinking
- Please note that wine's temperature is always lower than ideal serving temperature, as the temperature will immediately rise 1–2°C when pouring into the glass.

SERVING TEMPERATURE TABLE

The wine's taste depends on right pouring temperature, which determines its flavour. We suggest the wine's temperature reaches the following degree when pouring:

Wine Type	Recommended Serving Temperature
Bordeaux red	18 °C
Louis Family dry red wine/Barolo	17 °C
Burgundy red/Bordeaux red	16 °C
Port	15 °C
Young Burgundy red	14 °C
Young red wine	12 °C
Young Beaujolais / all white wines with little residual sugar	11 °C
Old white wines/Chardonnay	10 °C
Sherry	9 °C
Young white wines from late vintage	8 °C
White wines Loire/Entre-deux-Mers	7 °C

Table 2 – Recommendations for setting zone temperature based on wine type.

Cleaning & Maintenance

DISCONNECTING THE WINE COOLER

Unplug power plug to disconnect the cooler.

WHEN NOT USING YOUR WINE CABINET FOR A SHORT PERIOD OF TIME (14 DAYS)

Simply unplug the unit.

WHEN NOT USING YOUR WINE CABINET FOR A LONG PERIOD OF TIME (IE. IN STORAGE)

- Unplug the cooler.
- Clean the cooler.
- Keep the cooler door open.

CLEANING

WARNING: Before cleaning the appliance, make sure it is switched off and disconnected from the power supply. Failure to do so can result in electric shock or injury.

We recommend to clean dust behind the cooler and on the ground regularly to improve the cooling effect and save energy. The interior of the cooler should be cleaned regularly to avoid odour. Cleaning procedure is below:

- Unplug power plug.
- Clean door seal with only clear water and give thorough wipe.
- Remove the timber shelves.
- Use slightly warm water and a little dish soap to clean cooler, timber shelves and chrome basket. Do not let water spill onto any operation control elements or illuminator on glazed door.

Important! Do not soak the timber racks or immerse them in water, this can lead to cracking or mould. Only use a dry cloth to clean or slightly moist cloth and allow the timber racks to naturally dry before re-installing.

- Reconnect and power cooler when cleaning is completed.

WARNING

Do not use hard brushes, steel wool, wire brushes, abrasives such as toothpastes, organic solvents (such as alcohol, acetone, banana oil, etc.), boiling water, acid or alkaline items to clean the cooler considering that this may damage the cooler surface and interior.

Do not rinse with water so as not to affect the electrical insulation properties.

Do not use detergent and solvent with sand or acid properties.

FAQ's & Troubleshooting

If an issue or fault is detected by your Wine Cabinet, an error code may be displayed on your display. These error codes are described below.

Error Code	Fault description
E1	Temperature sensor error of upper zone
E2	Temperature sensor error of lower zone
E6	Communication fault
E7	Ambient temperature fault
E9	High temperature alarm
EL	Low temperature alarm
F7	Low temperature detection sensor fault of upper zone
F8	Low temperature detection sensor fault of lower zone

Table 3 – Error codes and the fault descriptions.

Problem	Possible Resolution
The appliance does not operate.	<ul style="list-style-type: none"> • Check whether the cooler is plugged and connected to power; • Low voltage; • Check whether temperature control knob is in the work area; • Failure power or tripping circuit.
Long-term operation of compressor.	<ul style="list-style-type: none"> • It is normal that cooler operates for longer time in summer when the ambient temperature is higher; • Do not store too much wine in the cooler at one time; • Frequent opening of cooler door.
LED light does not shine	<ul style="list-style-type: none"> • Check whether the chiller is connected to power • The LED is damaged. Contact our After Sales Support on 1300 11 4357.
Loud noises	<ul style="list-style-type: none"> • Check whether the cooler is level and the cooler is stable • Check whether the cooler accessories are properly placed.
Cooler enclosure heat condensation	<ul style="list-style-type: none"> • The cooler enclosure may emit heat during operation. Especially in summer, this is caused by the radiation of the condenser, and it is a normal phenomenon. • Condensation: condensation phenomenon will be detected on the exterior surface and door seals of the cooler when the ambient humidity is high, this is a normal phenomenon, and after wiping with towel, turns up the set temperature of the appliance properly.
Airflow sound Buzz Clatter	<ul style="list-style-type: none"> • Refrigerants circulating in the refrigerant lines will produce eruption of sound and grunts which is normal does not affect the cooling effect. • Buzz will be generated by running compressor specially when starting up or shutting down. • The solenoid valve or electric switch valve will clatter which is a normal phenomenon and does not affect the operation.

Table 4 – Troubleshooting guide for common issues.

Technical Specifications

Model Code	GGSWC193
Total Storage Volume	430L
Dimensions (W x D x H)	595 x 705 x 1845mm
Weight (Net/Gross)	86.6kg / 95.4kg
Features	193 Bottle Storage Capacity 5–18 °C Temperature Range Dual Zone Maintains Humidity at 50–80% Anti Vibration Low-E Glass Protects from UV Rays

**Attach your receipt
to this page**



Warranty Information

WARRANTY TERMS & CONDITIONS

This document sets out the terms and conditions of the product warranties for Residentia Group Appliances. It is an important document. Please keep it with your proof of purchase documents in a safe place for future reference should you require service for your Appliance.

1. IN THIS WARRANTY

- (a) 'acceptable quality' as referred to in clause 10 of this warranty has the same meaning referred to in the ACL;
 - (b) 'ACL' means Trade Practices Amendment (Australian Consumer Law) Act (No.2) 2010;
 - (c) 'Appliance' means any Residentia Group product purchased by you accompanied by this document;
 - (d) 'ASR' means Residentia Group authorised service representative;
 - (e) 'Residentia Group' means Residentia Group Pty Ltd of 165 Barkly Ave, Burnley VIC 3121, ACN 600 546 656 in respect of Appliances purchased in Australia;
 - (f) 'major failure' as referred to in clause 10 of this warranty has the same meaning referred to in the ACL and includes a situation when an Appliance cannot be repaired or it is uneconomic for Residentia Group, at its discretion, to repair an Appliance during the Warranty Period;
 - (g) 'Warranty Period' means:
 - (i) where the Appliance is used for personal, domestic or household use (i.e. normal single family use) as set out in the instruction manual, the Appliance is warranted against manufacturing defects for 24 months, following the date of original purchase of the Appliance;
 - (h) 'you' means the purchaser of the Appliance not having purchased the Appliance for re-sale, and 'your' has a corresponding meaning.
2. This warranty only applies to Appliances purchased and used in Australia and is in addition to (and does not exclude, restrict, or modify in any way) any non-excludable statutory warranties in Australia.
 3. During the Warranty Period Residentia Group or its ASR will, at no extra charge if your Appliance is readily accessible for service, without special equipment and subject to these terms and conditions, repair or replace any parts which it considers to be defective. Residentia Group or its ASR may use remanufactured parts to repair your Appliance. You agree that any replaced Appliances or parts become the property of Residentia Group. This warranty does not apply to light globes, batteries, filters or similar perishable parts.
 4. Parts and Appliances not supplied by Residentia Group are not covered by this warranty.

5. You will bear the cost of transportation, travel and delivery of the Appliance to and from Residentia Group or its ASR. If you reside outside of the service area, you will bear the cost of:
 - (a) travel of an authorised representative;
 - (b) transportation and delivery of the Appliance to and from Residentia Group or its ASR, in all instances, unless the Appliance is transported by Residentia Group or its ASR, the Appliance is transported at the owner's cost and risk while in transit to and from Residentia Group or its ASR.
6. Proof of purchase is required before you can make a claim under this warranty.
7. You may not make a claim under this warranty unless the defect claimed is due to faulty or defective parts or workmanship. Residentia Group is not liable in the following situations (which are not exhaustive):
 - (a) the Appliance is damaged by:
 - (i) accident
 - (ii) misuse or abuse, including failure to properly maintain or service
 - (iii) normal wear and tear
 - (iv) power surges, electrical storm damage or incorrect power supply
 - (v) incomplete or improper installation
 - (vi) incorrect, improper or inappropriate operation
 - (vii) insect or vermin infestation
 - (viii) failure to comply with any additional instructions supplied with the Appliance;
 - (b) the Appliance is modified without authority from Residentia Group in writing;
 - (c) the Appliance's serial number or warranty seal has been removed or defaced;
 - (d) the Appliance was serviced or repaired by anyone other than Residentia Group, an authorised repairer or ASR.
8. This warranty, the contract to which it relates and the relationship between you and Residentia Group are governed by the law applicable where the Appliance was purchased.
9. To the extent permitted by law, Residentia Group excludes all warranties and liabilities (other than as contained in this document) including liability for any loss or damage whether direct or indirect arising from your purchase, use or non use of the Appliance.
10. For Appliances and services provided by Residentia Group in Australia, the Appliances come with a guarantee by Residentia Group that cannot be excluded under the Australian Consumer Law. You are entitled to a replacement or refund for a major failure and for compensation for any other reasonably foreseeable loss or damage. You are also entitled to have the Appliance repaired or replaced if the Appliance fails to be of acceptable quality and the failure does not amount to a major failure. The benefits to you given by this warranty are in addition to your other rights and remedies under a law in relation to the Appliances or services to which the warranty relates.
11. At all times during the Warranty Period, Residentia Group shall, at its discretion, determine whether repair, replacement or refund will apply if an Appliance has a valid warranty claim applicable to it.
12. Missing parts are not covered by warranty. Residentia Group reserves the right to assess each request for missing parts in a case by case basis. Any parts that are not reported missing in the first week after purchase will not provide free of charge.
13. To enquire about claiming under this warranty, please follow these steps:
 - (a) carefully check the operating instructions, user manual and the terms of this warranty;
 - (b) have the model and serial number of the Appliance available;
 - (c) have the proof of purchase (e.g. an invoice) available;
 - (d) telephone the numbers shown below.
14. You accept that if you make a warranty claim, Residentia Group and its ASR may exchange information in relation to you to enable Residentia Group to meet its obligations under this warranty.

IMPORTANT

Before calling for service, please ensure that the steps in point 13 have been followed.

Telephone contacts

- ▶ Service: Please call 1300 11 HELP (4357)
- ▶ Spare Parts: Please call 1300 11 SPARE (7727)

The Australian Consumer Law requires the inclusion of the following statement with this warranty:

Our goods come with guarantees that cannot be excluded under the Australian Consumer Law. You are entitled to a replacement or refund for a major failure and for compensation for any other reasonably foreseeable loss or damage. You are also entitled to have the goods repaired or replaced if the goods fail to be of acceptable quality and the failure does not amount to a major failure.

**An initiative by
Residentia Group**



ESSENTIALS FOR LIFE

**T. 1300 11 4357
E. support@residentiagroup.com.au**

www.solt.house



E2447

SÔLT